

PLAN & PROFILE

CARROLL PARKWAY

280317

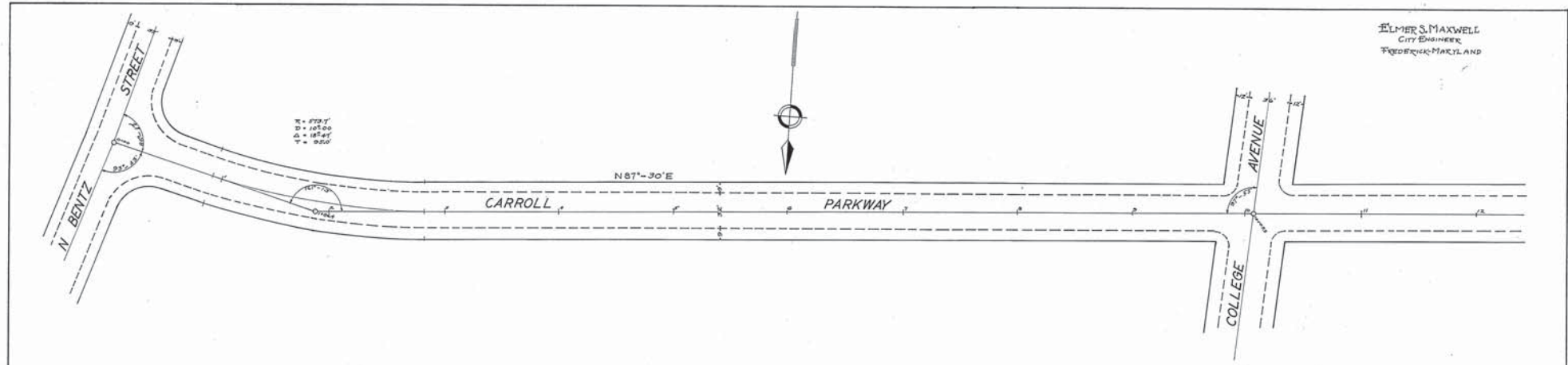

ELMER S. MAXWELL  
CITY ENGINEER  
FREDERICK, MARYLAND

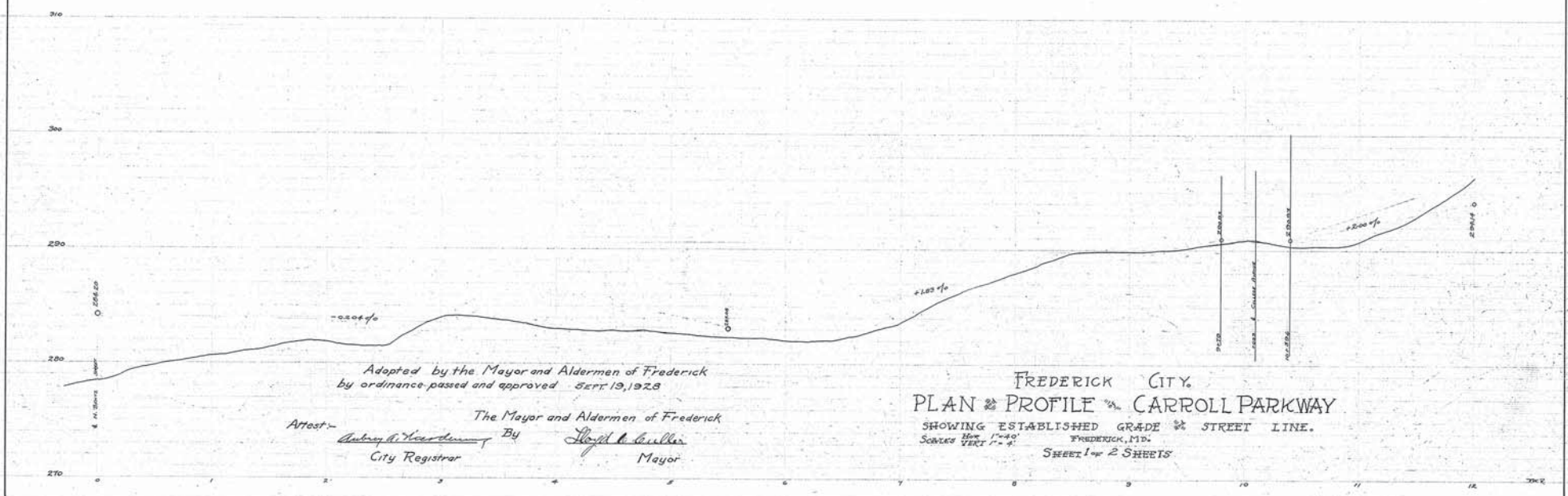

Adopted by the Mayor and Aldermen of Frederick  
by ordinance passed and approved Sept 19, 1928

Attest: *Anthony A. [Signature]* By *loyd A. [Signature]*  
City Registrar Mayor

FREDERICK CITY  
PLAN & PROFILE OF CARROLL PARKWAY  
SHOWING ESTABLISHED GRADE & STREET LINE.  
SCALE: HORIZ. 1"=40' VERT. 1"=4'  
FREDERICK, MD.  
SHEET 1 OF 2 SHEETS

No. 280317

ELMER S. MAXWELL  
CITY ENGINEER  
FREDRICK, MD.

FREDRICK COUNTY  
BOARD OF EDUCATION

FREDRICK COUNTY  
BOARD OF EDUCATION

VIRGINIA RENOULT ESTATE

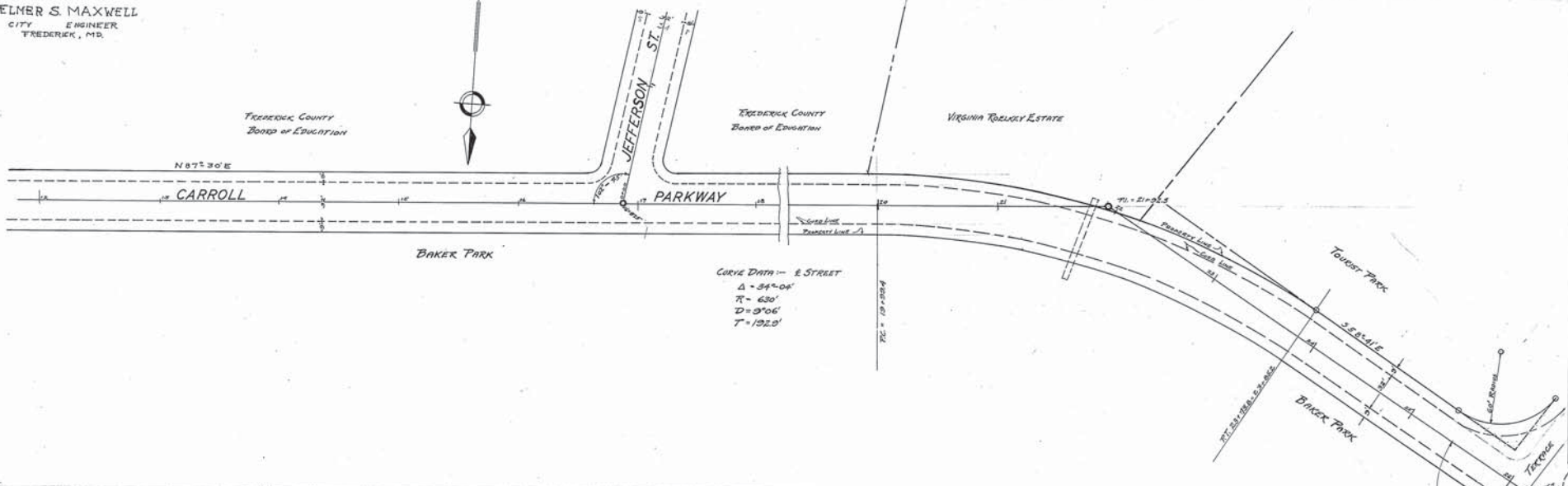

CURVE DATA - 2 STREET  
Δ = 54° 04'  
R = 630'  
D = 9' 06"  
T = 132.0'

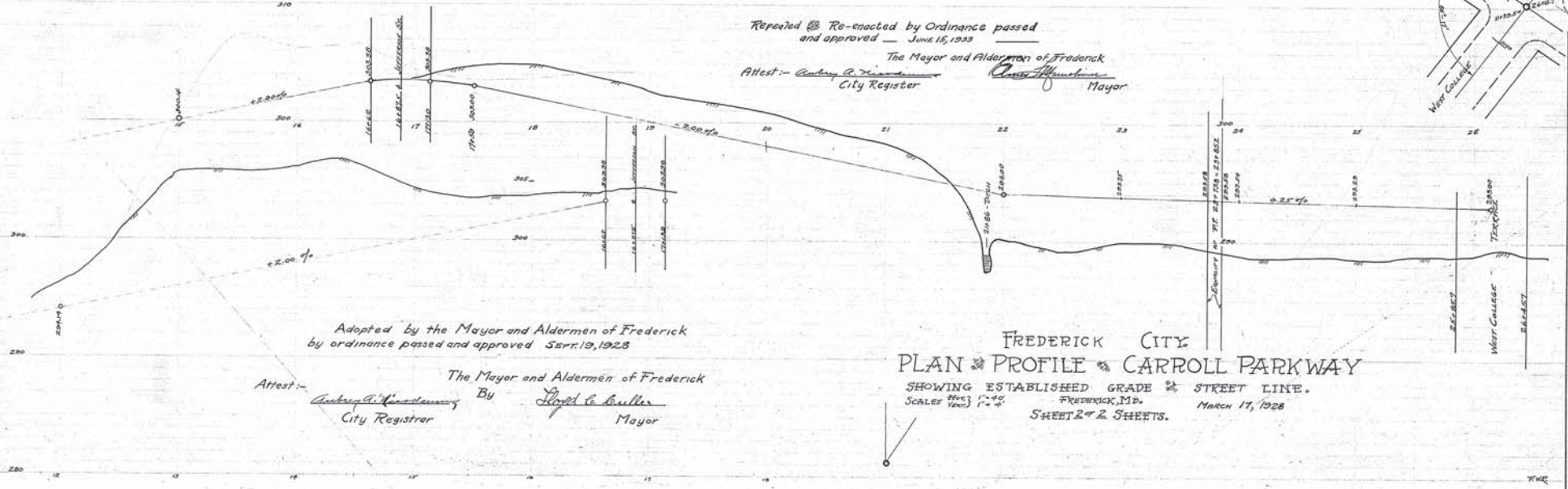

Repealed & Re-enacted by Ordinance passed  
and approved June 15, 1923

The Mayor and Aldermen of Frederick

Attest: *Andrew G. Henderson* City Register  
*Charles Affleck* Mayor

Adopted by the Mayor and Aldermen of Frederick  
by ordinance passed and approved Sept. 19, 1928

Attest: *Andrew G. Henderson* City Register  
By *Clayton C. Butler* Mayor

### FREDRICK CITY PLAN & PROFILE OF CARROLL PARKWAY

SHOWING ESTABLISHED GRADE & STREET LINE.

SCALE: Horiz. 1" = 40' Vert. 1" = 4'

FREDRICK, MD.

March 17, 1928

SHEET 2 OF 2 SHEETS.