

B.M. - 29025 Top Curb S.W. Cor. Bridge
 B.M. - 29133 Top Round H.E. Cor. Alder's House.

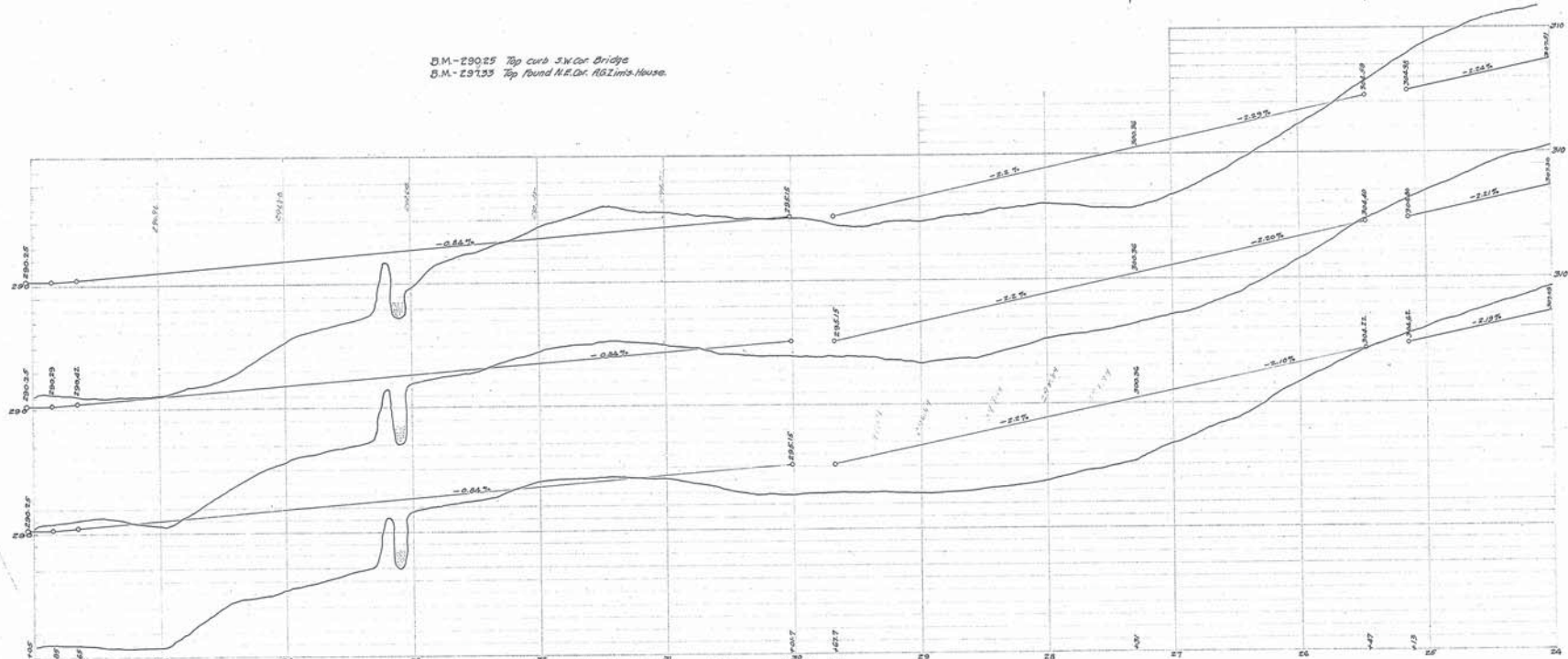

Adopted by The Mayor and Aldermen of Frederick
 by ordinance passed and approved June 16, 1916.

Attest- *Aubrey A. Maddeaux*
 City Registrar

The Mayor and Aldermen of Frederick
 By *Lewis H. Joubert*
 Mayor.

FREDERICK CITY
 PLAN & PROFILE OF COLLEGE AVENUE
 SHOWING ESTABLISHED GRADE & STREET LINES
 Frederick, Md.
 Feb. 21, 1914

Scales: 1" = 40' Hor.
 1" = 4' Vert.

SHEET 3 OF SHEETS.

230626-A

PLAN & PROFILE

COLLEGE AVENUE

EMORY CCRUM
CITY ENGINEER
Frederick, Maryland

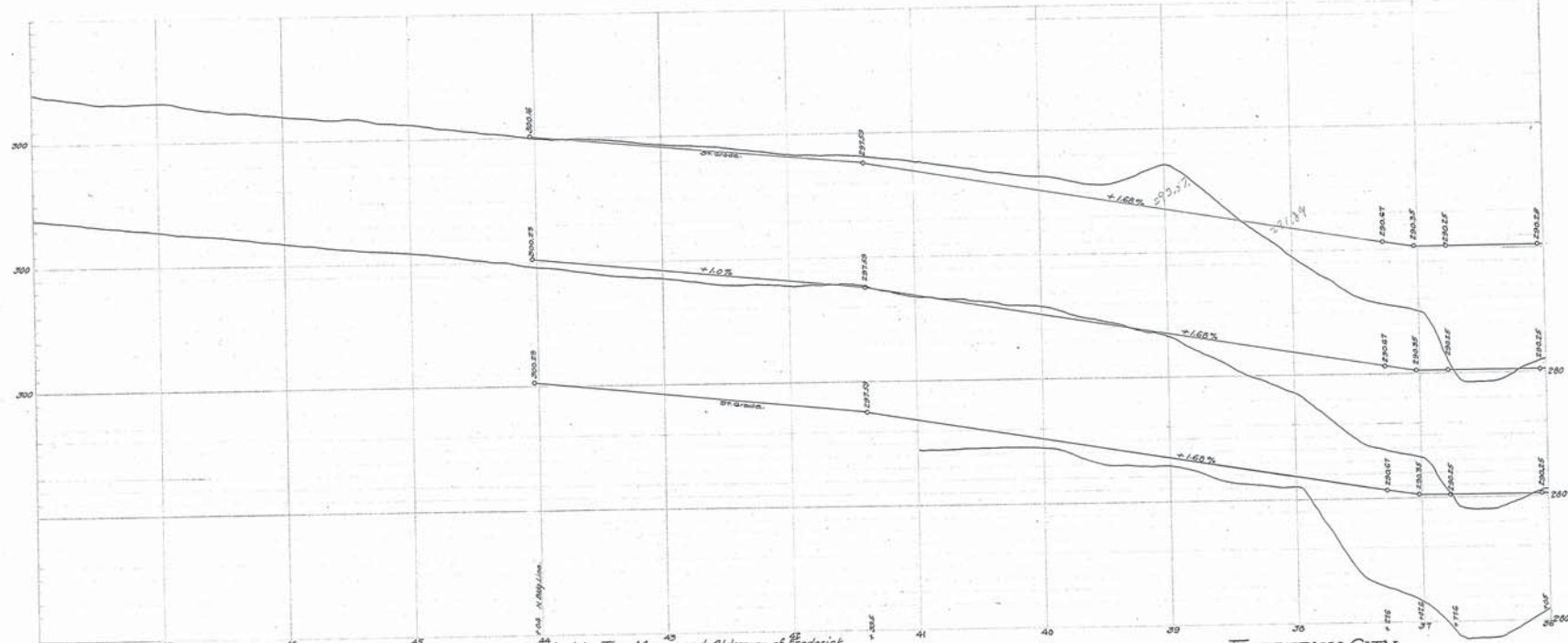
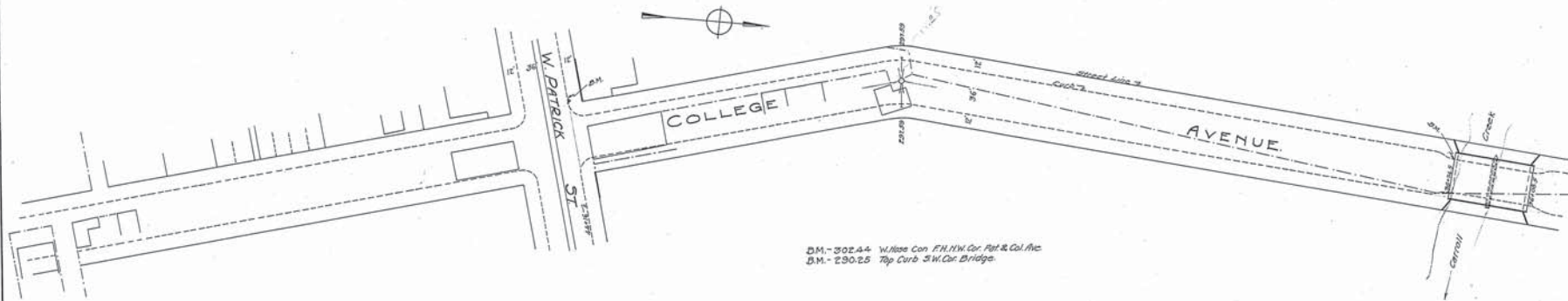

Adopted by The Mayor and Aldermen of Frederick
by ordinance passed and approved March 23, 1926.

Attest:
Anthony A. Hinkelman
City Registrar

The Mayor and Aldermen of Frederick
By *Stef. C. Buller*
Mayor

FREDERICK CITY
PLAN & PROFILE OF COLLEGE AVENUE
SHOWING ESTABLISHED GRADE & STREET LINES
Frederick, Md.
Jan 12, 1925

Scales: 1"=40' Hor.
1"=4' Vert.

SHEET 4 OF SHEETS.

No. 230626-A